

TILLAMOOK COUNTY SURVEYORS OFFICE  
COURTHOUSE, TILLAMOOK, OREGON 97141

WITNESS CORNER TO

MEANDER CORNER COMMON TO SECTIONS 7 & 8 T.1S., R.10W., W.M.

T1SR10W	I found a railroad spike set by John L. Carlich RS
WC   MC	287. See T.C.S. Map #A-1024, South 37.48' of the
S7 + S8	Meander Corner on the South side of Cape Meares Lake.
	I replaced it with a 3" Tillamook County Surveyors
NORTH 37.48'	Brass Cap on a 5/8" X 12" iron bar in an 8" cast
1991	iron monument case and encased in concrete.

-----  
History of found monument

The position for this corner is now in the lake, do to the construction of a dam which raised the water level, and is inaccessible.

I found this monument, used for the witness corner, to be as described in said T.C.S. Map #A-1024, And I found references as follows:

-----  
[G.L.O. Book 1S10 page 36 Oct. 1857]

Set post for corner; (Not found).

28" spruce N.42 E. 65 lks.; (Found, now a rotten stump with rotten face and axe marks visible bears N.22 E. 74.6' from this witness corner).

45" Spruce S.42 W. 85 lks.; (gone).

-----  
[Field notebook "H" page 67, 3-4-1886]

Set stone 13 X 11 X 7 for M.C. from original NE B.T.; (Now gone).

45" spruce S.42 W. 100 lks.; (gone).

-----  
[Survey Book S3 page 152, 4-15-1898]

Set spruce limb from original government witness; (Now gone).

-----  
[T.C.S. Rewitness Book 4 at Page 68, 1949 & 1953]

Set 2" iron pipe at position of found rusty pipe and spruce stake (Gone, position now in lake).

Rescribed original 28" spruce, reported as a 38" at N.42 E. 42.4'; (current condition reported above).

8" spruce S.47 30'W. 35.4'; (Now Gone)

1 1/2" iron pipe S.61 30'E 49.57'; (Found, now bears N.75 E. 47.00' from this Witness Corner).

1 1/2" iron pipe? S.5 W. 65.40'; (Gone).

\*indicates Tillamook County Surveyors yellow metal location poster attached.

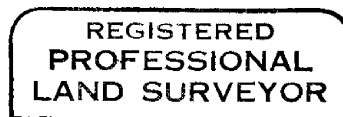

*Allan E. Duncan, C.S.*

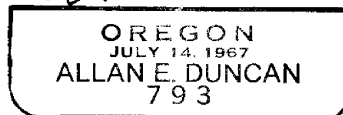

TILLAMOOK COUNTY SURVEYORS OFFICE  
COURTHOUSE, TILLAMOOK, OREGON 97141

WITNESS CORNER TO

MEANDER CORNER COMMON TO SECTIONS 7 & 8 T.1S., R.10W., W.M.

New Accessories

\*72" light hat section post S.37 E. 15.2'.

Power pole #078700 S.65 W. 99.96'. The distance was measured to a scribed triangle with a hub tack in the side center of the pole.

5/8" iron rod with a yellow plastic cap inscribed C.W.Cook LS 1098 bears South 41.65' (record = South 41.66' T.C.S. map #A-4099.

Map References and Rewitnesses

A-4489	6-19-81	Alan E. Duncan	LS 793
A-4099	March 1980	C.W. Cook	LS 1098
A-2305	Sept. 1972	John L. Carlich	LS 287
A-4957	June 1970	W.A. Markham	PE 1842
A-4958	June 1970	W.A. Markham	PE 1842
A-4959	June 1970	W.A. Markham	PE 1842
A-4960	June 1970	W.A. Markham	PE 1842
A-4961	June 1970	W.A. Markham	PE 1842
A-1024	Aug. 1962	John L. Carlich	LS 287
A-658	June 1956	John L. Carlich	LS 287
A-153	May 1946	W.E. Anderson	
A-7	April 1945	W.S. Coates	CE
Field notebook "H" page 67	3-4-1886	R.R. Hayes	
Field notebook "CT 6" page 64	12-2-11	U.G. Jackson	CS
Survey Book S3 Page 152	4-15-1898	A.M. Austin	
T.C.S. Witness Book 4 page 68		W.E. Anderson	CS
G.L.O. Book 1S10 page 36	Oct. 1857	Samuel D. Snowden	contract #67

Location of Monument

This Witness Corner is located approximately 0.6' Northerly of the Apparent centerline of Bay Ocean County Road and approximately 280' NEly of the intersection of Bay Ocean-Oceanside Road.

In the presence of Al Dvorak and Dan McNutt

July 2, 1991

Title:

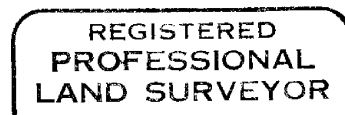
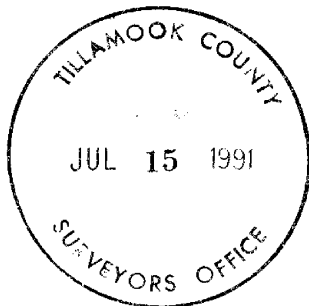

*Allan E Duncan, C.S.*

